



• 3,



Low Coast

- 1st/reverse (B3)
Low

2-3

2-3

97741-18K

F-39741-TL18 & VB-FIX

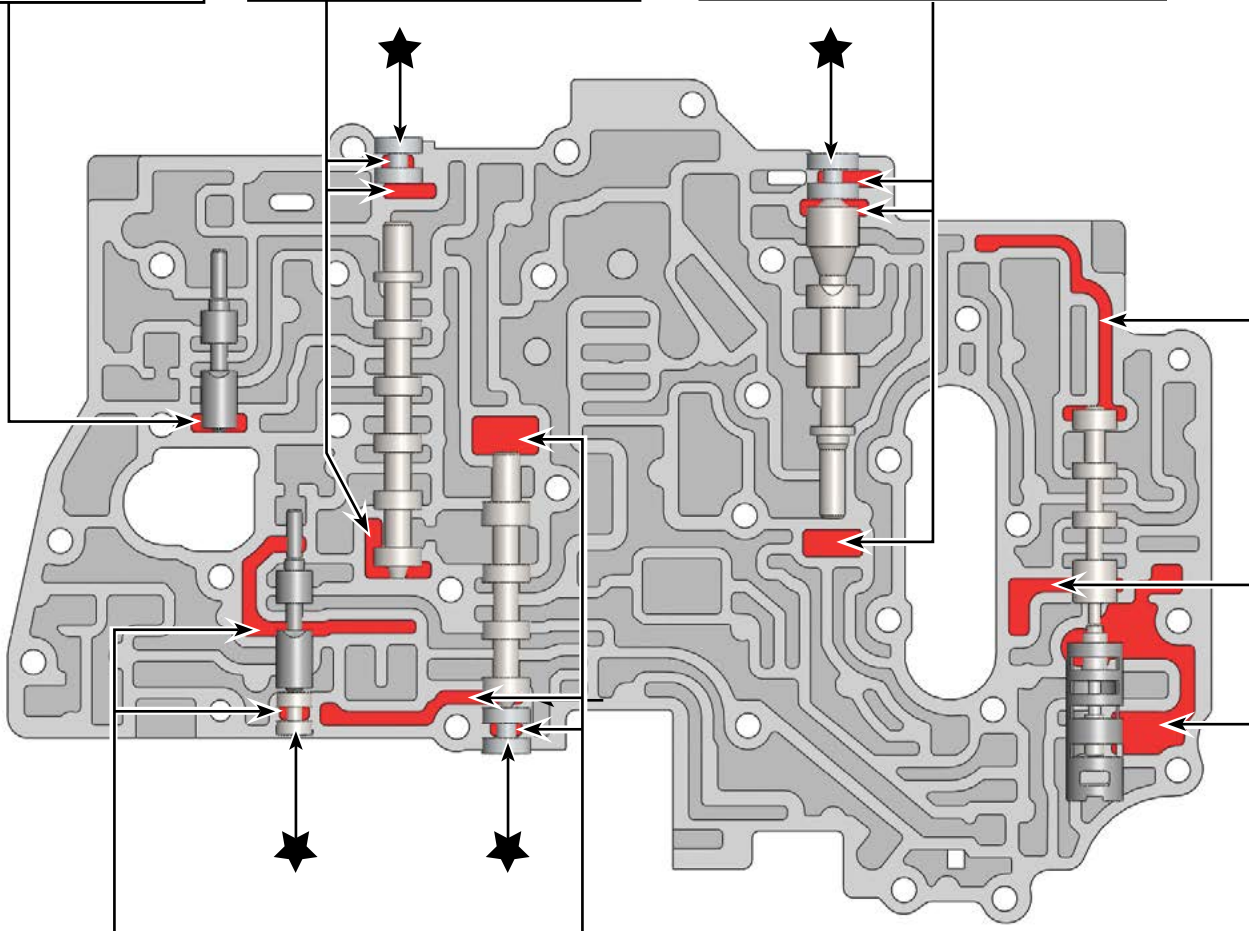

2nd Coast

2nd brake (B2)

2-

3-4

3-4

77741-02K
97741-20K

97741-20K:

F-97741-TL20 & VB-FIX

97741-19K

= ★

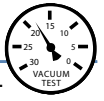

• 3.



•		
•		
•		
•		
	97741-06K	10,88
		2-
	97741-10K	8,97
		3-
	97741-06K & 97741-10K:	F-97741-TL6 & VB-FIX

•		
•		
	97741-19K	=★

	1-2
	1-2

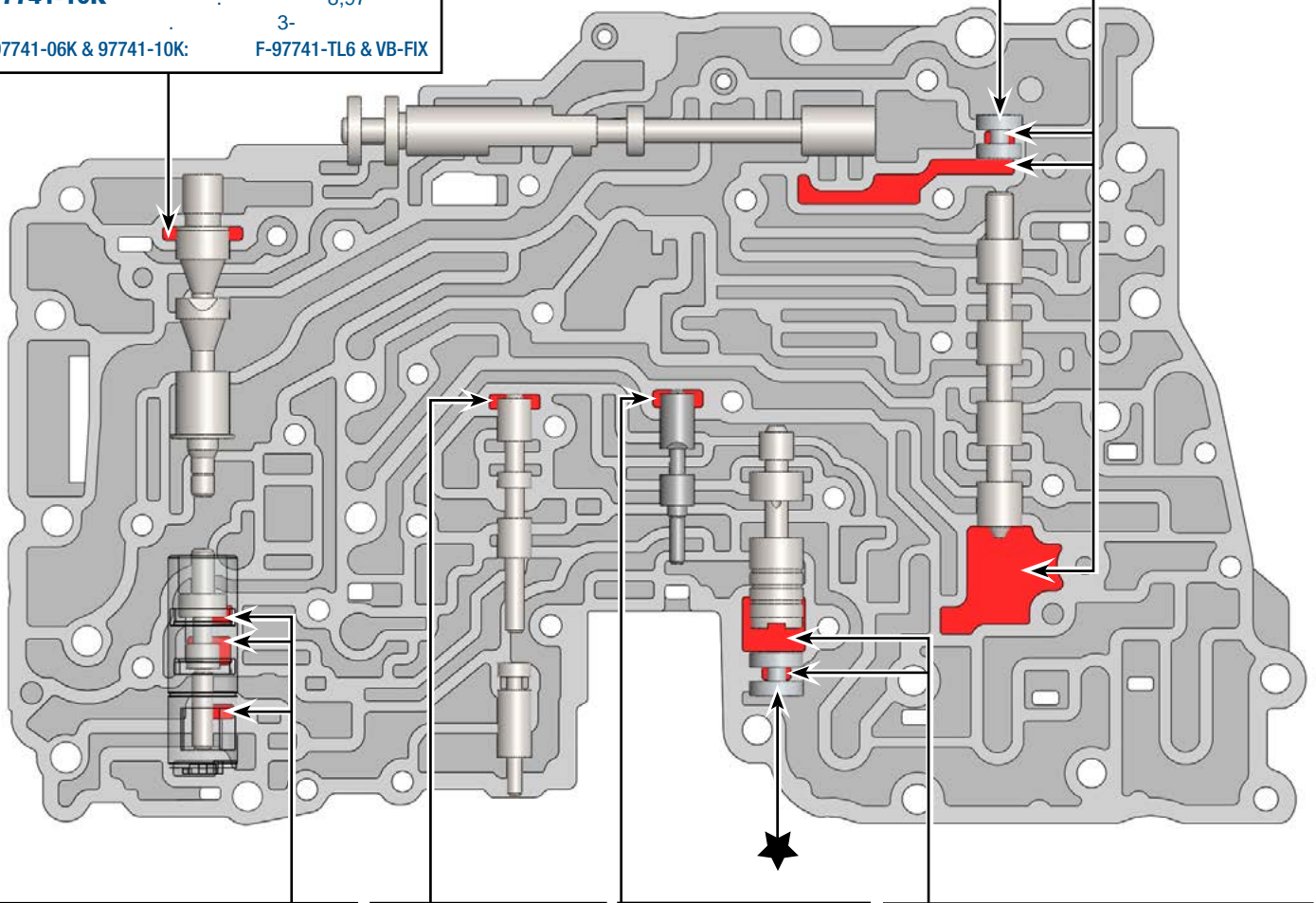

•		forward/reverse
•		
•		
•		
	97741-01K	

•		
•		

•		
•		

•		
•		



• 4.

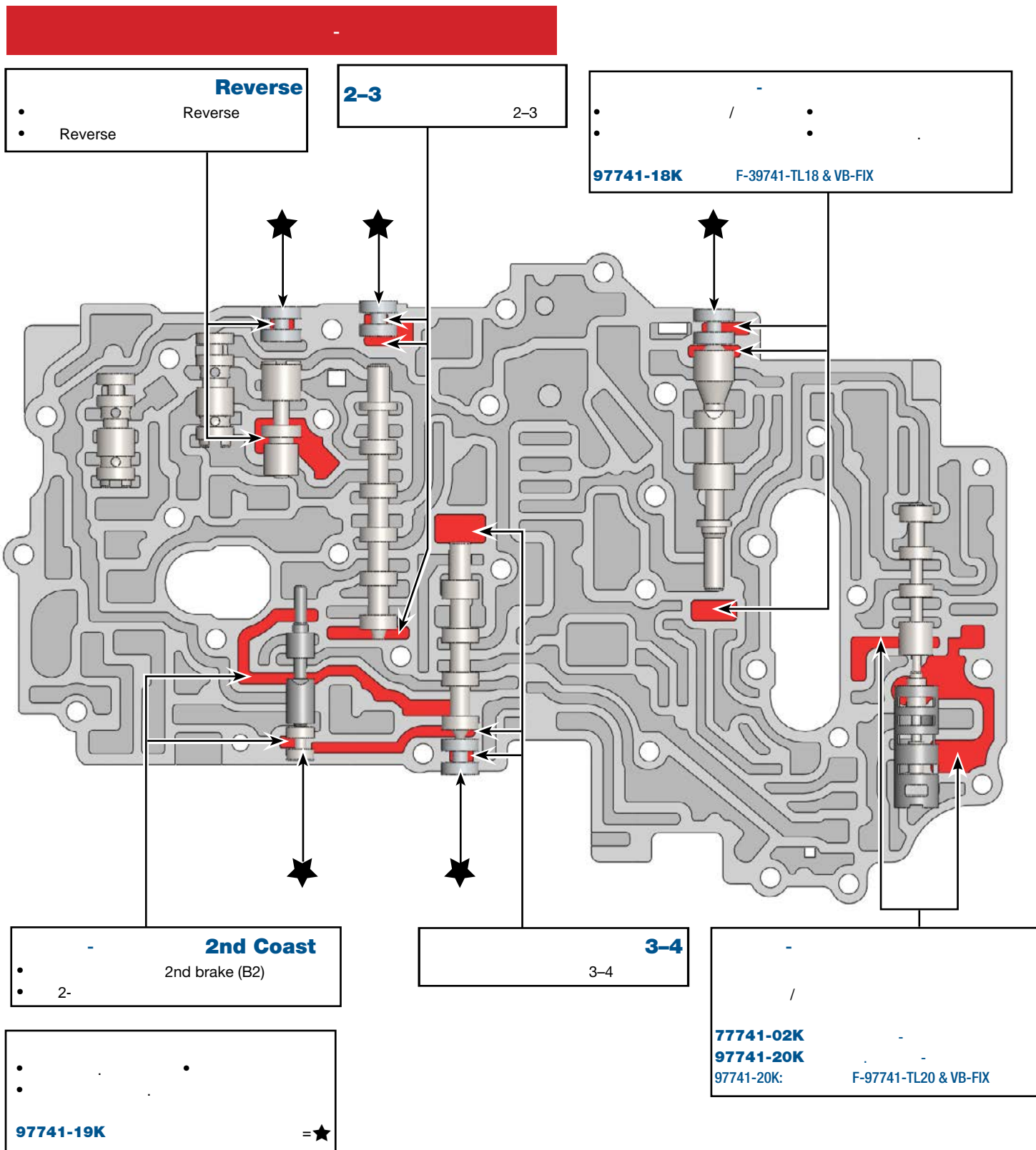



• 4.

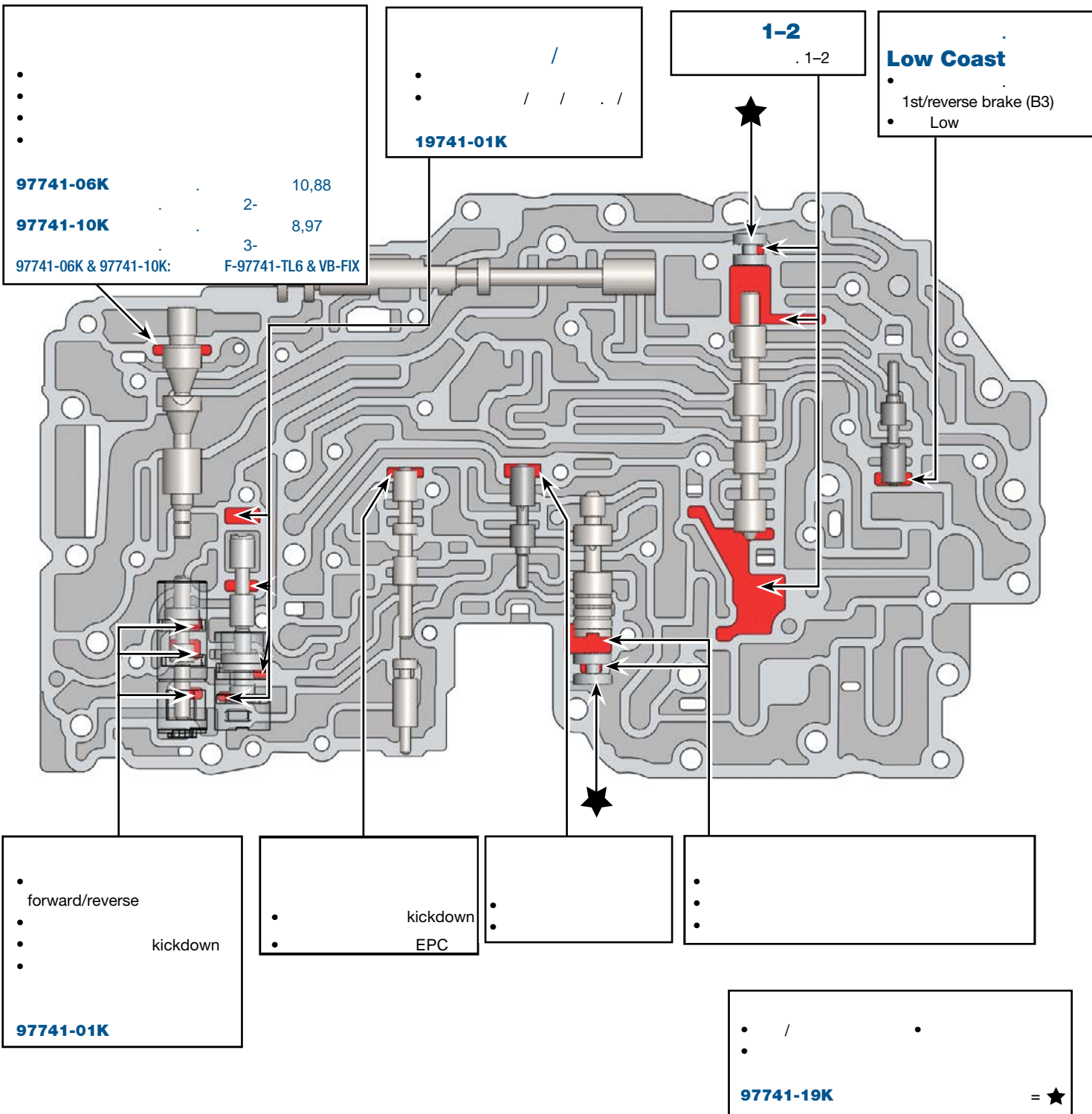

• 3,

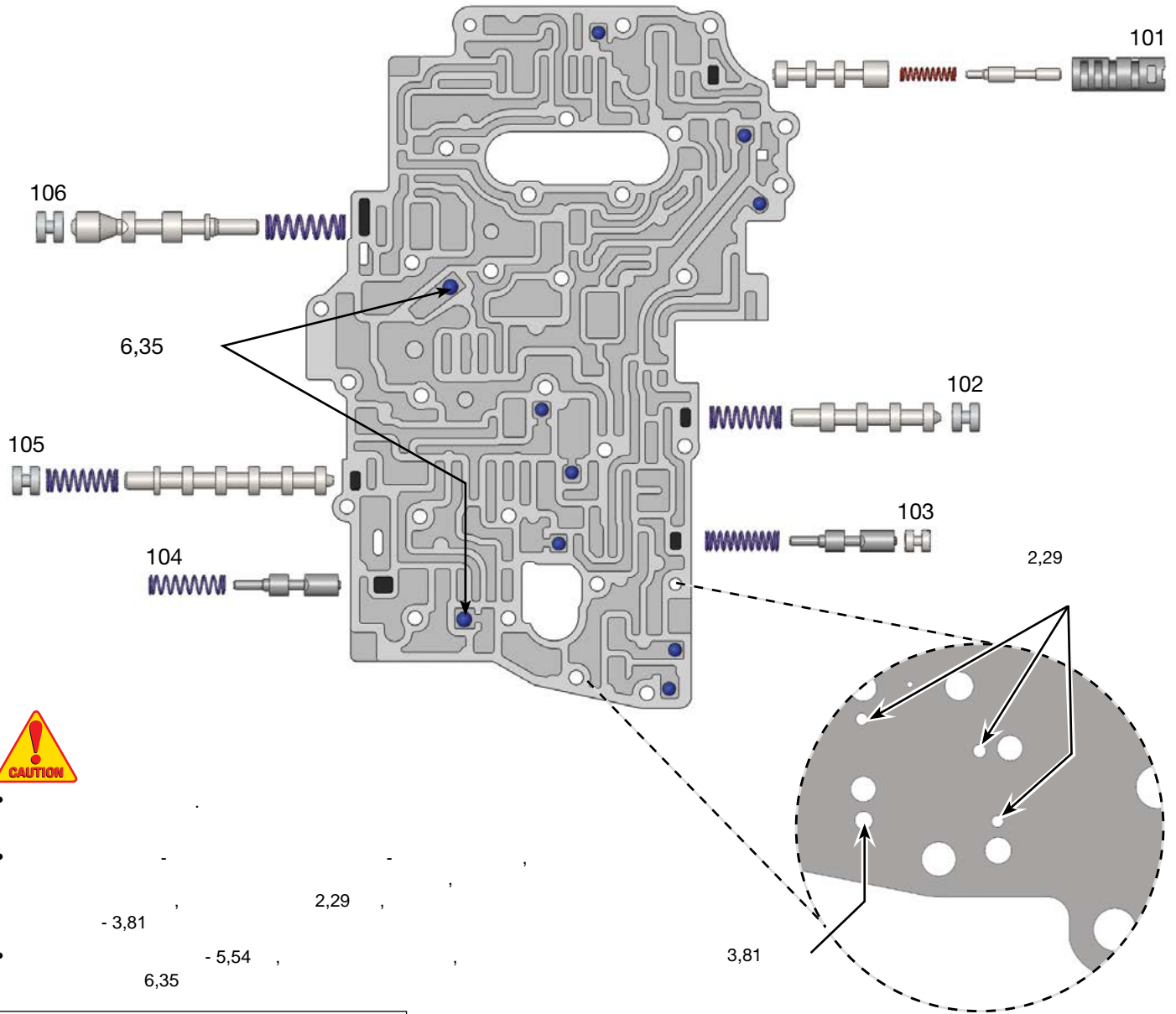

101	-
102	3-4
103	. 2nd Coast
104	. Low Coast
105	2-3
106	.



• 3,

201	
202	
203	
204	
205	/
206	
207	1-2

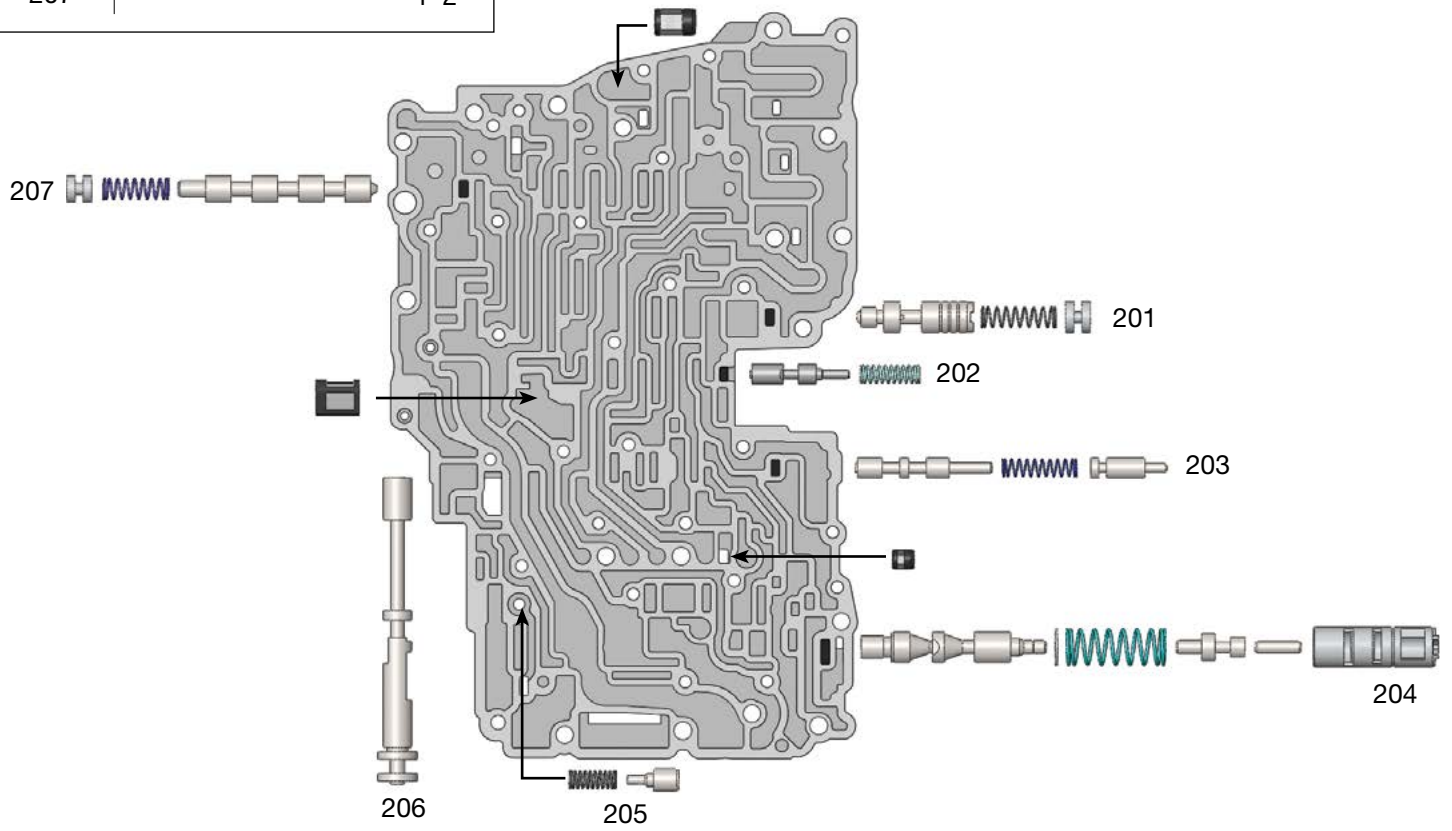



• 4,

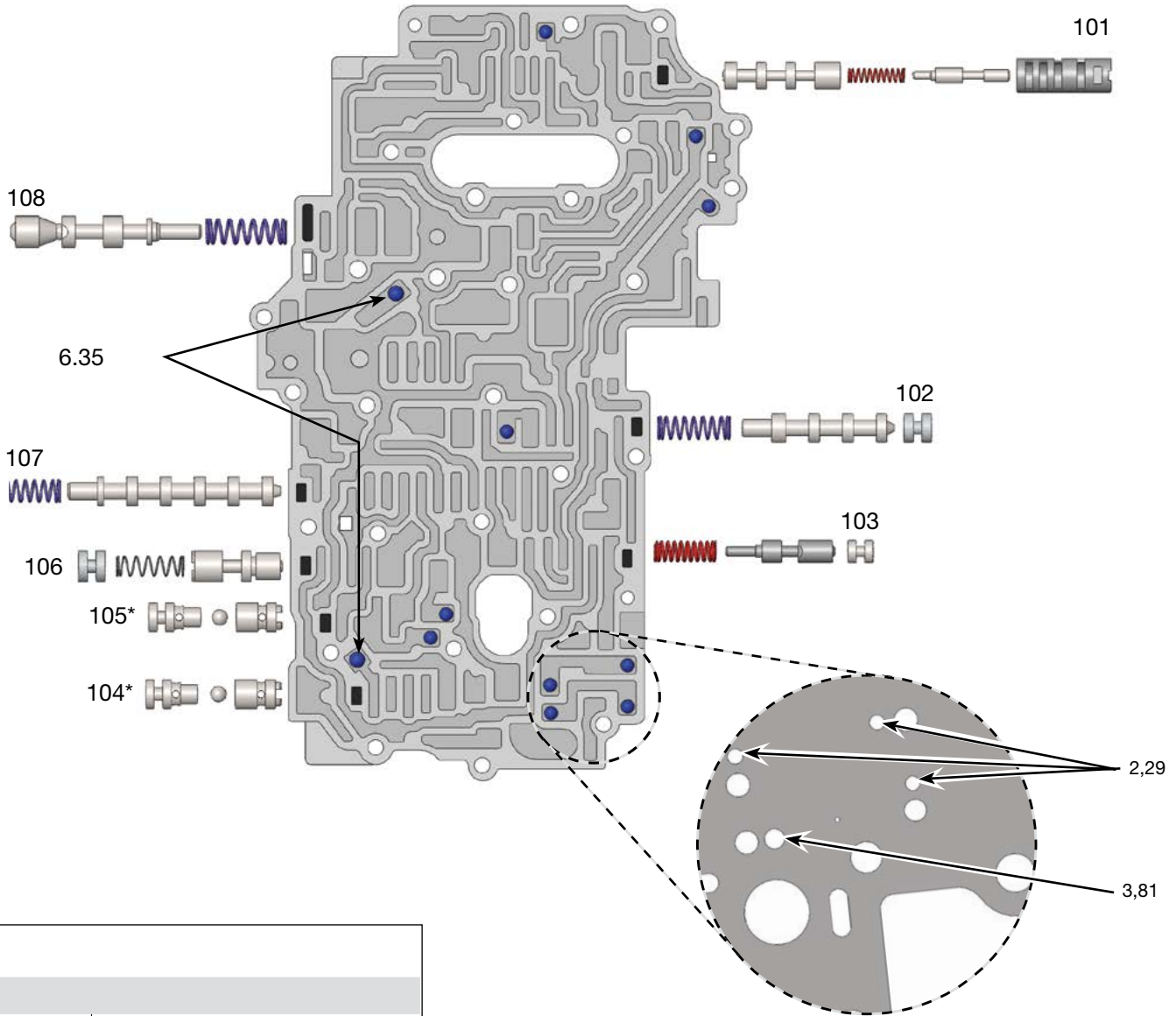

101	-
102	3-4
103	. 2nd Coast
104*	
105*	
106	Reverse
107	2-3
108	-
* -	-



- !
- , 2,28 , - 3,81
- 6,35 5,54 , ,



• 4,

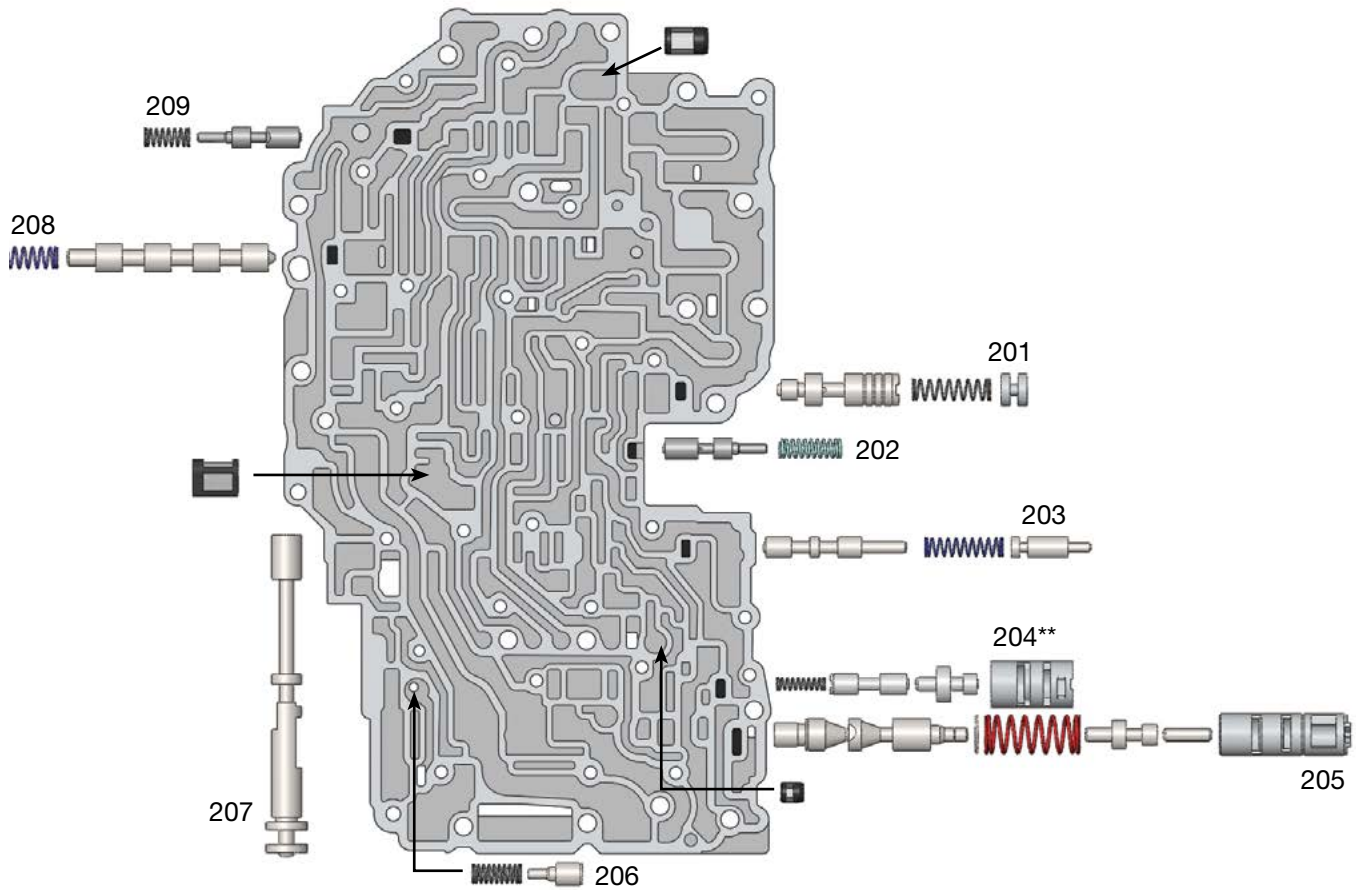

201	-
202	-
203	
204**	.
205	-
206	
207	
208	1-2
209	. Low Coast
**	